





5 Ellenborough Drive Cooranbong NSW

4  2  5 

Located in the exclusive Ellenborough Park Estate, this exquisite family home has been perfectly designed as an escape from the hustle and bustle of life. Brilliantly positioned on the high side of the street in this gated community, the superb family home has plenty of space and seamlessly marries indoor and outdoor living.

Set on a large 1600m² block, the impressive floorplan features four bedrooms plus a study, a large master with full bathroom-sized ensuite and multiple living areas. There's a stunning central kitchen at the hub of the home plus a collection of outdoor alfresco spaces including a spa and a sparkling saltwater pool. In addition to the double garage, there's that sought-after drive through, side access to a second double garage. Measuring 6m x 7m, this

Type : House
Price : \$ 1,450,000
Land Size : 1600 sqm
View : <https://www.renshaw.realestate/sale/nsw/lake-macquarie-west/cooranbong/residential/house/8078023>



Brad Renshaw
 02 4977 3555

[For full version visit the website](https://www.renshaw.realestate)



5 Ellenborough Avenue, Cooranbong

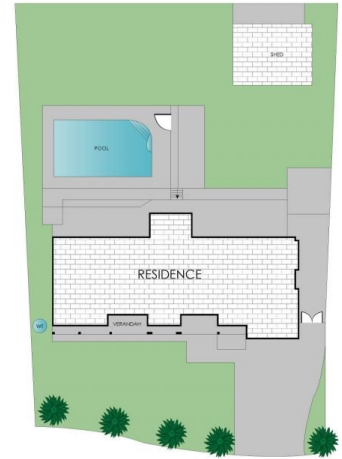

NOTE: Every precaution has been taken to verify the accuracy of the above details. However, prospective purchasers are advised to make their own enquiries.