



12 Bowerbird Avenue Cooranbong NSW

4  2  2 

Ring Bec on 0455 630 253 for your appointment!

Flawlessly designed by Beechwood Homes, this family entertainer promises a luxurious lifestyle on a substantial 648sqm corner block in Watagan Park. The residence reveals a well-conceived layout perfect for all families, offering an open living area that transitions seamlessly to the alfresco area, together with separate rumpus and media rooms. The secure yard space is surrounded by established gardens and lawns capturing afternoon sunsets and mountain views. This is an incredible opportunity for both families and retirees alike to relish in low maintenance substantial property with allocated space for your caravan or boat.

Type : House
Price : \$ 928,000
Building Size : 183 sqm
Land Size : 647 sqm
View : <https://www.renshaw.realestate/sale/nsw/lake-macquarie-west/cooranbong/residential/house/8078863>



Brad Renshaw
02 4977 2555

[For full version visit the website](https://www.renshaw.realestate)



4 x 2 x 2 x

Internal 200m² External 453m² Total 653m²

12 Bowerbird Avenue, Cooranbong

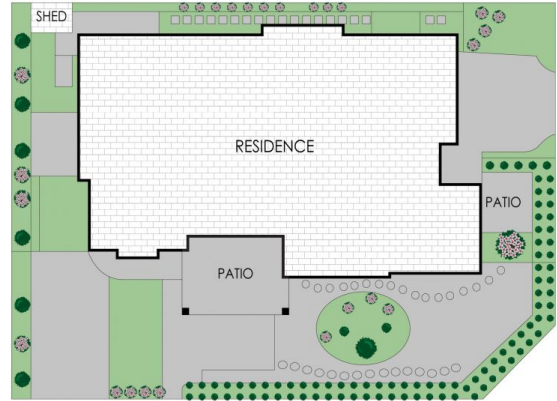

NOTE: Every precaution has been taken to verify the accuracy of the above details. However, prospective purchasers are advised to make their own enquiries.